

A project by



COMMON FEATURES

- Kids play area
- Senior citizen meeting zone
- Designed landscape - landscapes and herb garden
- Sitting on walkways

SECURITY

- 24 x 7 security (CCTV cameras at gates, cellar, kids play area and clubhouse)
- Each unit will be connected to security ofce through intercom
- Compound wall with solar fencing

OUTDOOR SPORTS

- Skating rink
- Cricket practice nets
- Volleyball court

- Basketball half court
- Badminton court
- Tennis court
- Walking and jogging tracks

LANDSCAPE

- Entrance lobby
- Tot lots surroundings
- Lawn with pathway
- Club house area



SILENT FEATURES

- Centralised laundry room
- 100% vastu
- Car /bike wash area

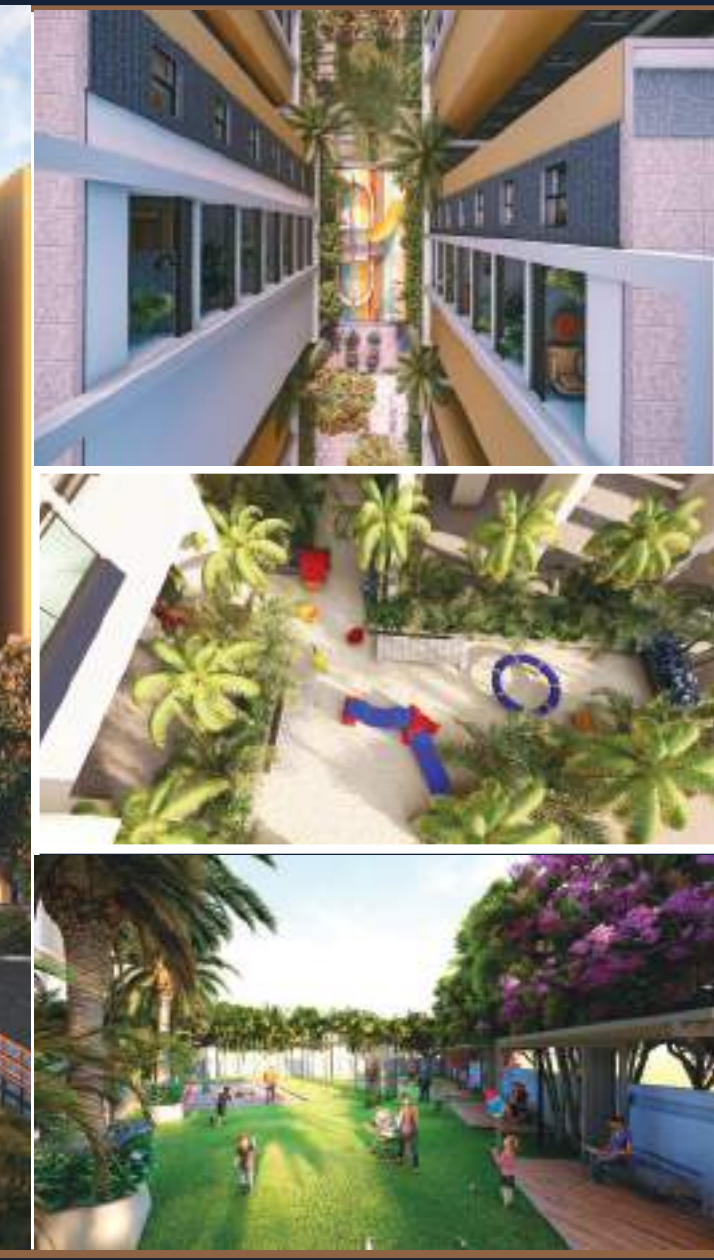

PROJECT HIGHLIGHTS

5 Majestic towers of luxury in 6 acres
2 Basement, Stilt + 7 floors, 637 Units
Grand entrance lobby for each block

2 and 3 BHK Apartments at size from 963 to 2107 Sft.
1 Clubhouse Tower area 25360 Sft.
Swimming pool and kids pool

- Well equipped children play area
- Visitors car parking
- Servant rest rooms
- Rainwater harvesting pits
- Servant / Drivers rest room



MASTER PLAN

A PRIZED POSSESSION! 6 ACRES

STILL+7 FLOORS | 2 LEVEL PARKING | 700 METERS JOGGING TRACK

5 TOWER | 637 INDEPENDENT FLATS

1 CLUB HOUSE TOWER G+6

LEGEND

- ENTRY / EXIT
- PLANTING
- JOGGING TRACK
- 7 MTRS FIRE DRIVEWAY
- COMPOUND WALL
- SWIMMING POOL
- DECK
- BASKETBALL COURT
- TENNIS COURT
- CHILDREN'S PLAY AREA
- CRICKET PRACTICE NET
- SKATING RINK
- 6" THK. PLANTER WALL
- CENTRAL COURTYARD
- BABY POOL
- PARTY LAWN
- BADMINTON COURT
- BAR COUNTER



A - BLOCK

S No.	Block	Flat No.	Facing	BHK	Plinth Area	Common Area	Saleable Area
1	A - Block	unit-1	West	3	1213	400	1613
2	A - Block	unit-2	West	3	1584	523	2107
3	A - Block	unit-3	West	3	1219	402	1621
4	A - Block	unit-4	West	3	1260	416	1676
5	A - Block	unit-5	East	2	996	329	1325
6	A - Block	unit-6	North	2	996	329	1325
7	A - Block	unit-7	East	3	1193	394	1587
8	A - Block	unit-8	East	2	880	290	1170
9	A - Block	unit-9	East	2	880	290	1170
10	A - Block	unit-10	East	3	1014	335	1349
11	A - Block	unit-11	West	2	914	302	1216
12	A - Block	unit-12	West	2	979	323	1302
13	A - Block	unit-13	West	2	906	299	1205
14	A - Block	unit-14	East	2	908	300	1208
15	A - Block	unit-15	East	2	908	300	1208
16	A - Block	unit-16	East	3	1038	343	1381

C - BLOCK

S No.	Block	Flat No.	Facing	BHK	Plinth Area	Common Area	Saleable Area
1	C - Block	Unit-1	West	3	1105	365	1470
2	C - Block	Unit-2	West	3	1105	365	1470
3	C - Block	Unit-3	West	3	1105	365	1470
4	C - Block	Unit-4	West	3	1115	368	1483
5	C - Block	Unit-5	North	2	949	313	1262
6	C - Block	Unit-6	North	2.5	1032	341	1373
7	C - Block	Unit-7	East	3	1431	472	1903
8	C - Block	Unit-8	East	3	1321	436	1757
9	C - Block	Unit-9	East	2	925	305	1230
10	C - Block	Unit-10	West	2	924	305	1229
11	C - Block	Unit-11	East	2	924	305	1229
12	C - Block	Unit-12	East	2	943	311	1254
13	C - Block	Unit-13	East	2	954	315	1269

D - BLOCK

S No.	Block	Flat No.	Facing	BHK	Plinth Area	Common Area	Saleable Area
1	D - Block	Unit-1	West	3	1172	387	1559
2	D - Block	Unit-2	West	3	1576	520	2096
3	D - Block	Unit-3	West	3	1171	386	1557
4	D - Block	Unit-4	West	3	1266	418	1684
5	D - Block	Unit-5	North	3	1202	397	1599
6	D - Block	Unit-6	North	3	1202	397	1599
7	D - Block	Unit-7	East	3	1280	422	1702
8	D - Block	Unit-8	East	2	944	312	1256
9	D - Block	Unit-9	East	2	944	312	1256
10	D - Block	Unit-10	East	3	1084	358	1442
11	D - Block	Unit-11	West	2	964	318	1282
12	D - Block	Unit-12	West	2	920	304	1224
13	D - Block	Unit-13	West	2	964	318	1282
14	D - Block	Unit-14	East	2	918	303	1221
15	D - Block	Unit-15	East	2	918	303	1221
16	D - Block	Unit-16	East	3	1098	362	1460

B - BLOCK

S No.	Block	Flat No.	Facing	BHK	Plinth Area	Common Area	Saleable Area
1	B - Block	Unit-1	West	3	1366	451	1817
2	B - Block	Unit-2	West	3	1399	476	1851
3	B - Block	Unit-3	North	3	1285	424	1709
4	B - Block	Unit-4	North	3	1138	376	1514
5	B - Block	Unit-5	East	3	1217	402	1619
6	B - Block	Unit-6	East	3	1183	390	1573
7	B - Block	Unit-7	East	3	1183	390	1573
8	B - Block	Unit-8	West	2	866	286	1152
9	B - Block	Unit-9	West	2	885	292	1177
10	B - Block	Unit-10	West	2	885	292	1177
11	B - Block	Unit-11	East	2	954	315	1269
12	B - Block	Unit-12	East	3	1097	362	1459

E - BLOCK

S No.	Block	Flat No.	Facing	BHK	Plinth Area	Common Area	Saleable Area
1	E - Block	Unit-1	West	3	1214	401	1615
2	E - Block	Unit-2	West	3	1214	401	1615
3	E - Block	Unit-3	West	3	1214	401	1615
4	E - Block	Unit-4	West	3	1247	412	1659
5	E - Block	Unit-5	North	2	978	323	1301
6	E - Block	Unit-6	North	2	978	323	1301
7	E - Block	Unit-7	North	2	978	323	1301
8	E - Block	Unit-8	North	2	978	323	1301
9	E - Block	Unit-9	North	2	978	323	1301
10	E - Block	Unit-10	North	2	1005	332	1337
11	E - Block	Unit-11	North	3	1143	377	1520
12	E - Block	Unit-12	North	3	1120	370	1490
13	E - Block	Unit-13	East	3	1296	428	1724
14	E - Block	Unit-14	East	3	1307	431	1738
15	E - Block	Unit-15	East	3	1307	431	1738
16	E - Block	Unit-16	East	3	1384	457	1841
17	E - Block	Unit-17	West	3	1288	425	1713
18	E - Block	Unit-18	West	2	936	309	1245
19	E - Block	Unit-19	West	3	1288	425	1713



2BHK
SIGNATURE TOWERS AT THUMUKUNTA
NORTH FACING - 2BHK BLOCK - A6



2BHK
SIGNATURE TOWERS AT THUMUKUNTA
WEST FACING - 2BHK BLOCK - C10



AERIAL VIEW



Finding the right place to build your dreams is as rare as a precious jewel. It must sparkle your imagination, offer you the aura of exclusivity and immerse you in an experience that will dazzle your circle. Presenting Asritha's Group for those moments of exclusivity you along with your loved ones can gleefully indulge and revel in.

At Asritha's Signature Towers, you are Guaranteed to have arrived at a gem of a place!

SPACE FOR EVERYTHING, DREAMS INCLUDED
AT SIGNATURE TOWERS



3BHK
SIGNATURE TOWERS AT THUMUKUNTA
EAST FACING - 3BHK BLOCK - C8



3BHK
SIGNATURE TOWERS AT THUMUKUNTA
WEST FACING - 3BHK BLOCK - A1



CLUBHOUSE AMENITIES

- | | | |
|----------------------|-------------------------|---------------------|
| Banquet Halls | Creche | Yoga / Meditation |
| Bakery / Coffee Shop | Saloon/beauty Parlour | Snooker / Spa |
| Co - Working Lounge | Indoor Games | 7 Guest Rooms |
| Super Market | Clinic / Doctor on Call | Cafeteria / Library |
| Gymnasium | 24/7 Nursing Facility | Mini Theatre |

With an array of exceptional Amenities ranging from the kids play area to a senior citizen meeting zone, Signature Towers has something to offer to every age group.

A Basket Ball Court, Swimming Pool, Cricket practice net, Volley Ball court, Walk/Jog Tracks & more which helps maintain the balance to provide an active and healthy lifestyle.

An exclusive 35 thousand sq.ft. Clubhouse built with 50+ World Class Amenities maintaining International premium standards hosts a gym, spa, guest rooms, Banquet hall and much more to look forward.

Connectivity

- 02 Min Drive To TS Sports School
- 05 Min Drive To ORR ESTE-07
- 09 Min Drive To BITS PILANI
- 10 Min Drive To Greeno Valley
- 10 Min Drive To Bollaram R.Station
- 15 Min Drive To NALSAR Law College
- 15 Min Drive To Kompally
- 15 Min Drive To Bio Tech Park
- 15 Min Drive To ICICI Knowledge Park
- Hitech City Cyber towers
- 15 Min Drive To Infosys Campus (Singapore Township) Through ORR
- 20 Min Drive To Jubilee Bus Station
- 30 Min Drive To SEC Railway Station
- 30 Min Drive To Gachibowli
- 60 Min Drive To RGDA Airport

LOCATION HIGHLIGHTS

- Aalankrita Resort And Convention, Leonia Resorts, Celebrity Resorts, Rajiv Rahadari To North Telangana Districts, Domus Villas And Resorts, Telangana State Sports School, Genome Valley, ICICI Knowledge Park, Shri Ramchandra Mission

Health Care

- Excel Hospitals, Meena multi speciality Hospital, Mother & Child Hospital, G.N.R Hospital, Alara, Yashoda Hospital, Aadiya Hospital, New Lifeline Medicare Hospitals, Government Civil Hospital

Education

- Saitaja Jr. And Degree College, Pebble Creek Life School, Rajarajanya, Dilshah - A Waldorf School, Iris Florets School, Thumukunta Global Values School, Sahyog Law Academy, Vishwa Vishwani Institute Of Bba&mba, Sri Vignana Bharathi High School, Bits Pilani Hyderabad, Nalsar Law University



LOCATION MAP NOT TO SCALE



EXTRAORDINARY LIFESTYLE IN THE LAP OF NATURE

<p>STRUCTURE RCC Framed structure: Footings columns, beams and slabs in RCC designed grade concrete.</p>	<p>TV & TELEPHONE Individual TV & Telephone points in Main Hall, Points in Master Bed Room and living room.</p>	<p>ELECTRICAL Electrical work : Concealed copper wiring with Anchor/Inolex ISI make. Plate switches and necessary points in each room and 15 amps Power plug points in kitchen and Toilets. Earthing Power plugs fire frames.</p>
<p>SUPER STRUCTURE CC Blocks External Walls of 6" and internal walls with 4" Solid.</p>	<p>KITCHEN PLATFORM Granite kitchen platform with stainless steel sink and 2 feet height glass tiles dado above the platform. Provision for washing machine and Gas Cylinder in utility.</p>	<p>PAINTING External : Texture / two coats premium paint. Internal : Texture / two coats premium paint.</p>
<p>PLASTERING Internal plastering - Single coat CM plastering with sponge finish. External plastering - Double coat CM plastering with sponge finish.</p>		

<p>SPECIFICATIONS</p>		<p>TOILETS</p> <ol style="list-style-type: none"> Wash basin and WC of CERA make or equivalent ISI brand. Hoe and cold mixture for shower, health faucet of CERA make or equivalent ISI brand in all toilets. Provision for Geysers in all toilets All CP fittings of equivalent make or ISI brand and SWR fitting with "Sudhakar make" or equivalent ISI brand. Glazed ceramic tiles dadoing of up to 7' height. Ceramic non-slippery flooring
<p>MAIN DOOR Main Door: Teak wood frame & aesthetically designed teak veneered shutter and finished with melamine polish fitted with reputed make hardware.</p>	<p>FLOORING Staircase, corridors, lobby, entrance lobby Vitrified tile flooring 2' X 2'</p> <p>WATER 24 hrs water deep tube wells to each block</p>	<p>LIFTS Johnson / OTIS / SCHINDLER or equivalent ISI brand.</p> <p>TERRACE ROOF Finished terrace, Cement mortar with waterproof.</p>
<p>INTERNAL DOORS Frames : Medium Teakwood frame of section size 4'X 3" and size of the door as per the Architectural plan with flush shutters in paint with standard fittings and locks.</p>	<p>MISCELLANEOUS ITEMS</p> <ol style="list-style-type: none"> Gate and compound wall : All round 4'6" height compound wall as per the design with elegantly designed gate, gate pillars. Provision of external Underground drainage connection. Water sump as per the requirement. Railing as per the design for steps & balconies. Elevation : As per the design. 	<p>GENERATOR ISI Branded, 100% backup power available to all common areas, lifts, lobbies and staircase.</p> <p>NOTE Flat will be handed over for wood work / interiors after receiving 100% payment only, subject to payment of facilitating cost as may be decided by builder.</p> <p>b) GST applicable as per Govt norms.</p>



The Project funded by

ASRITHA'S GROUP
a symbol of joyful life

hmda
Growing Global

ASRITHA'S GROUP
a symbol of joyful life

ITS PERA

IIFL

CORPORATE OFFICE
Door No 112, 3rd Floor, Kavuri Hills Phase 1, ICONIA Building,
Opp. Jubilee Ridge Hotel, Madhapur, Hyderabad, Telangana-500033
E-mail:sales@asrithasgroup.com www.asrithasgroup.com

For Enquiries Contact: +91 733 733 6695, 733 733 6696

NOTE: This brochure is only a conceptual presentation of the project and not a legal offering. The promoters reserve the right to make changes in plans, specifications and elevation as deemed fit.